

# D-LINE SOLUTION

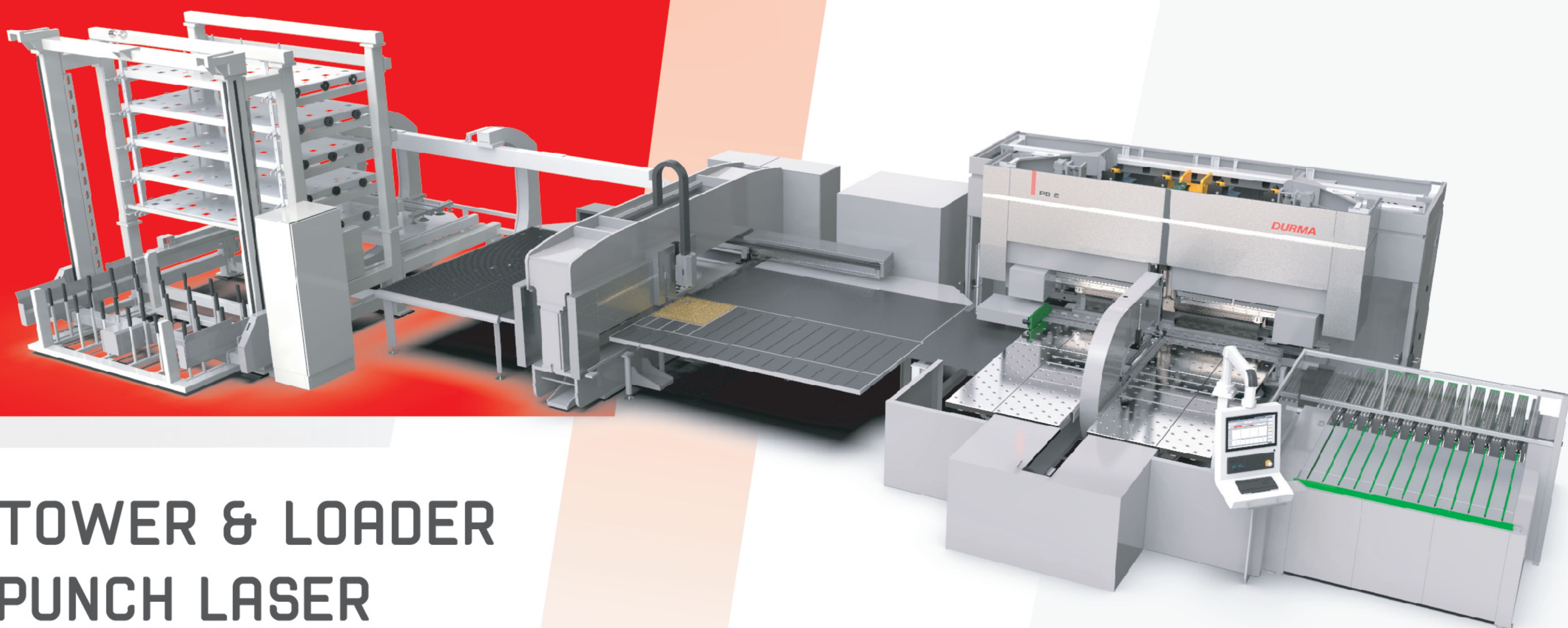

- ✓ TOWER & LOADER
- ✓ PUNCH LASER
- ✓ BENDING CENTER
- ✓ SUPERVISOR

SUPERVISOR - SOLUTION  
MANAGEMENT SYSTEM



## ✓ TOWER & LOADER

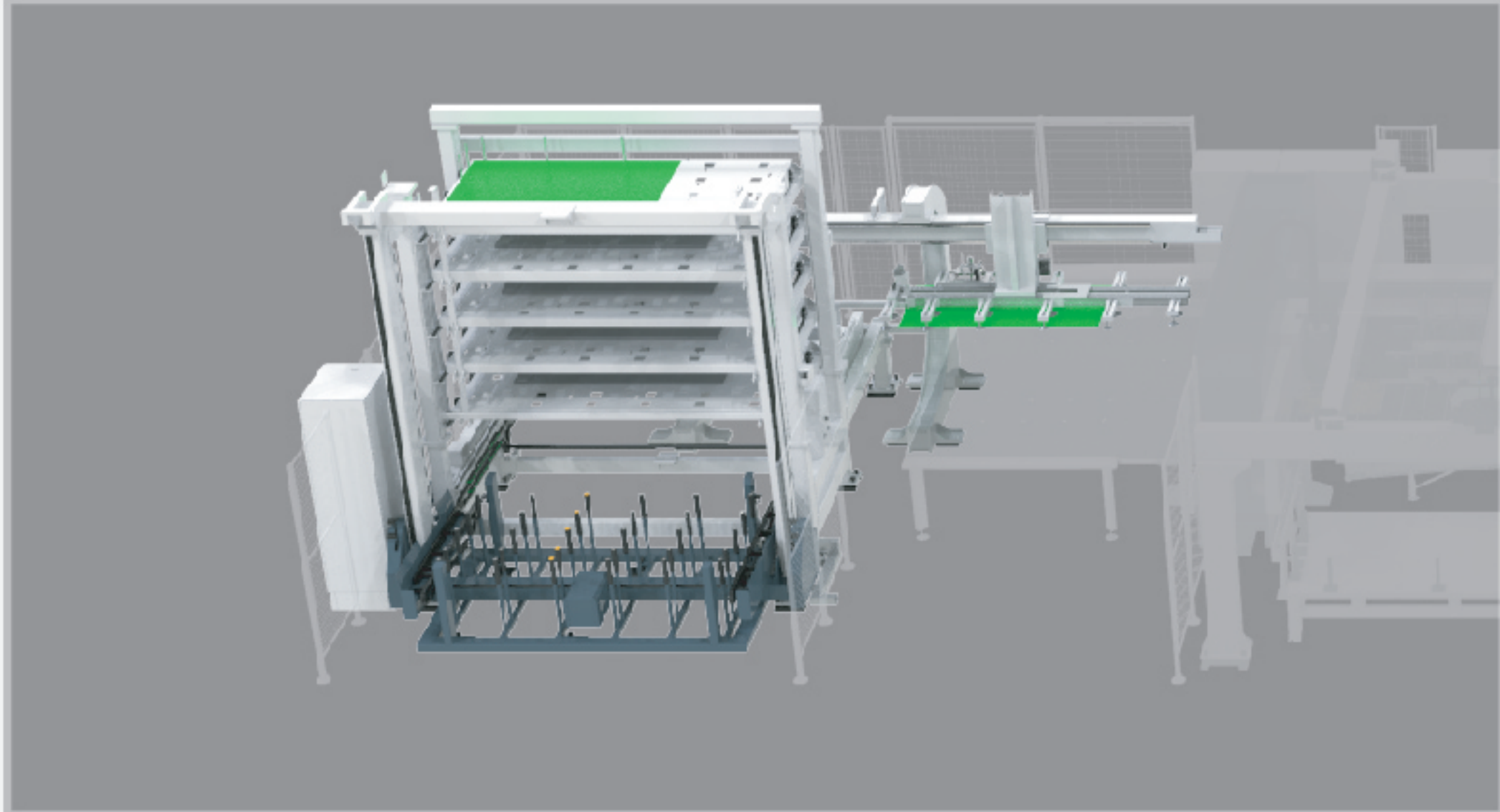

### Technical Data

Max. Sheet Size	3048x1524 mm
Min. Sheet Size	1000x1000 mm
Thickness	0,5-25 mm
Payload Per Pallet	3000 kg
Number of Pallet	5 (with wooden pallet) 10 (without wooden pallet)
Max. Sheet Weight	15000 / 30000 kg
Max. Sheet Stack Height	150+85 mm

## ✓ SUPERVISOR



### Technical Data

User Friendly
Drag and Drop List Management
ERP Integration
Line Monitoring
Alarm/Work History
All Machines One Page
Storage Monitoring
Alarm Monitoring

## ✓ BENDING CENTER

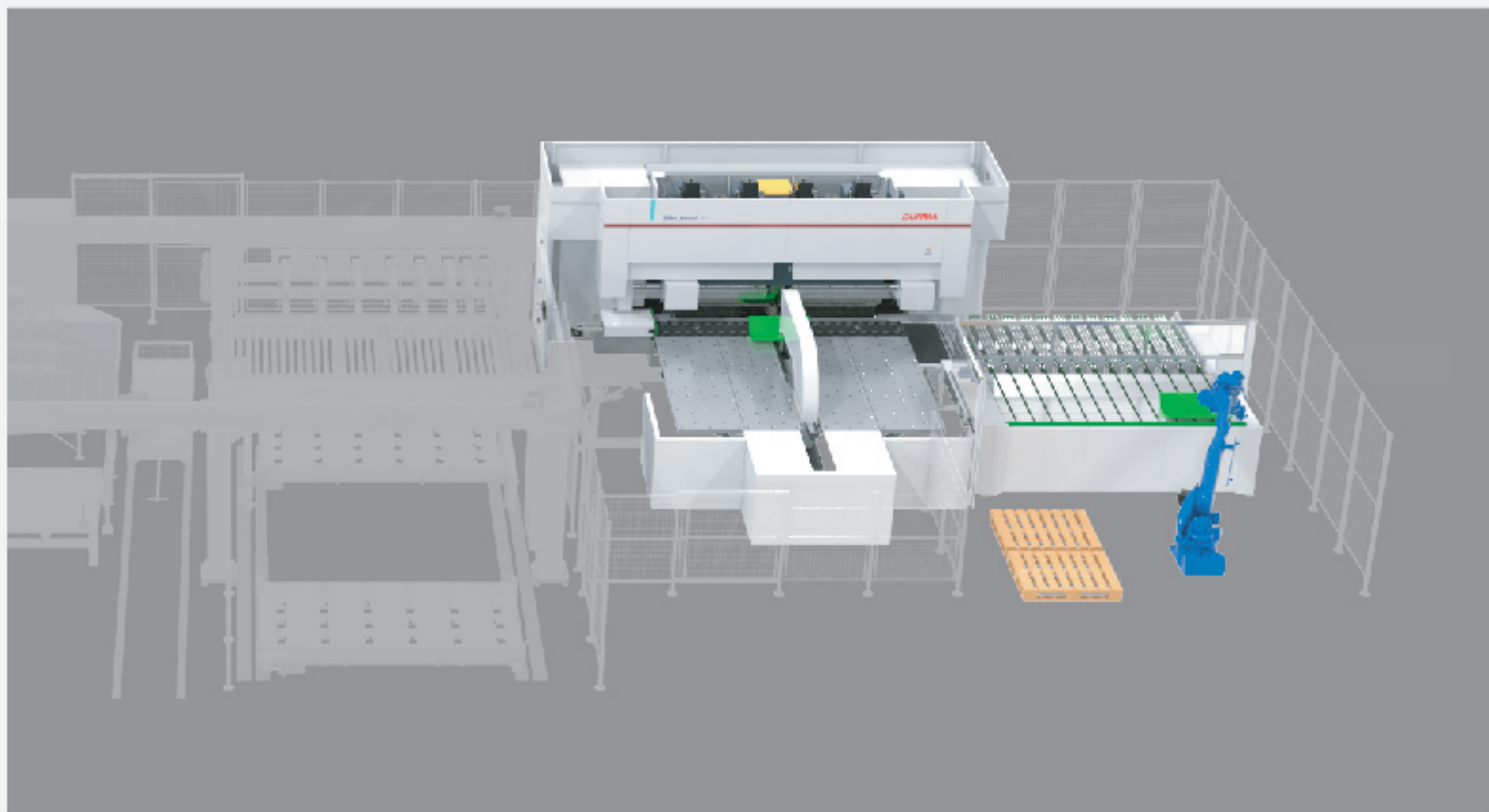

### Technical Data

Max. Bending Length	2250 mm
Min. Bending Length	350 mm
Max. Bending Width	1500 mm
Min. Bending Width	150 mm
Max. Bending Height	254 mm
Bending Force	320 kN
Holding Force	520 kN
For Fe 410 N/mm <sup>2</sup> Material	2,5 mm
For Inox 600 N/mm <sup>2</sup> Material	1,8 mm
For Al 260 N/mm <sup>2</sup> Material	3,5 mm
Minimum Sheet Thickness	0,5 mm
Max. Bending Angle In One Step	135°

## ✓ PUNCH LASER

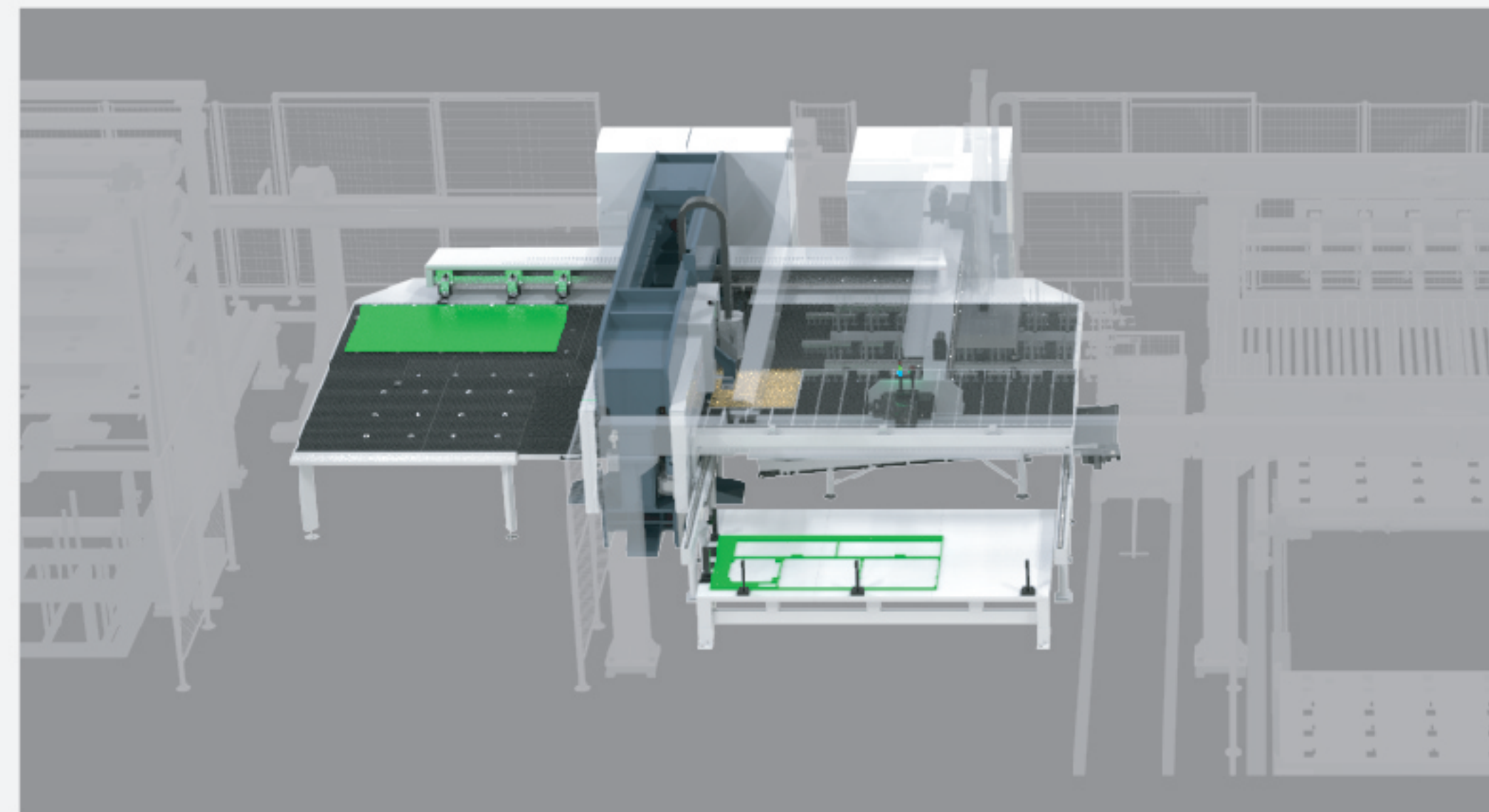

### Technical Data

Maximum Tonnage	20 ton
X Axis Movement	3000+R mm
Y Axis Movement With Single Tool	1500 mm
Speed of Y Axis	100 m/min
Speed of X Axis	120 m/min
Lateral Speed Y + X	150 m/min
Max. Thickness Fixed Station	6 mm (MS) 3 mm (SS)
Max. Thickness Index Station	3 mm (MS) 1,5 mm (SS)
Average Consumption	4,5-6,5 kWh

